



# Quail Meadows

167th & Waverly

Gardner, KS

www.quailmeadowscommunity.com

## Phase 1

Lot #	Lot sq. ft.
1	14,300
2	10,400
3	12,184
4	14,855
11	18,234
12	9,488
13	16,789
14	11,115
15	18,062
16	14,089
17	14,028
18	14,122
19	16,118
20	14,322
21	14,415
22	14,509
23	17,534
24	12,118
25	8,400
26	8,400
27	8,400
28	8,400
29	8,400
30	8,400
31	9,722
32	11,479
33	15,892
34	17,876
35	12,197
36	11,109
37	11,552
38	11,077
39	13,912
40	12,720
41	9,600
42	10,605
43	12,820
44	17,716
45	19,793
46	13,072
47	10,686
48	10,043
49	10,368
50	10,627
51	10,604
52	17,076

**SALES PLAT**  
**QUAIL MEADOWS**  
 CITY OF GARDNER  
 JOHNSON COUNTY, KANSAS

### Phase I

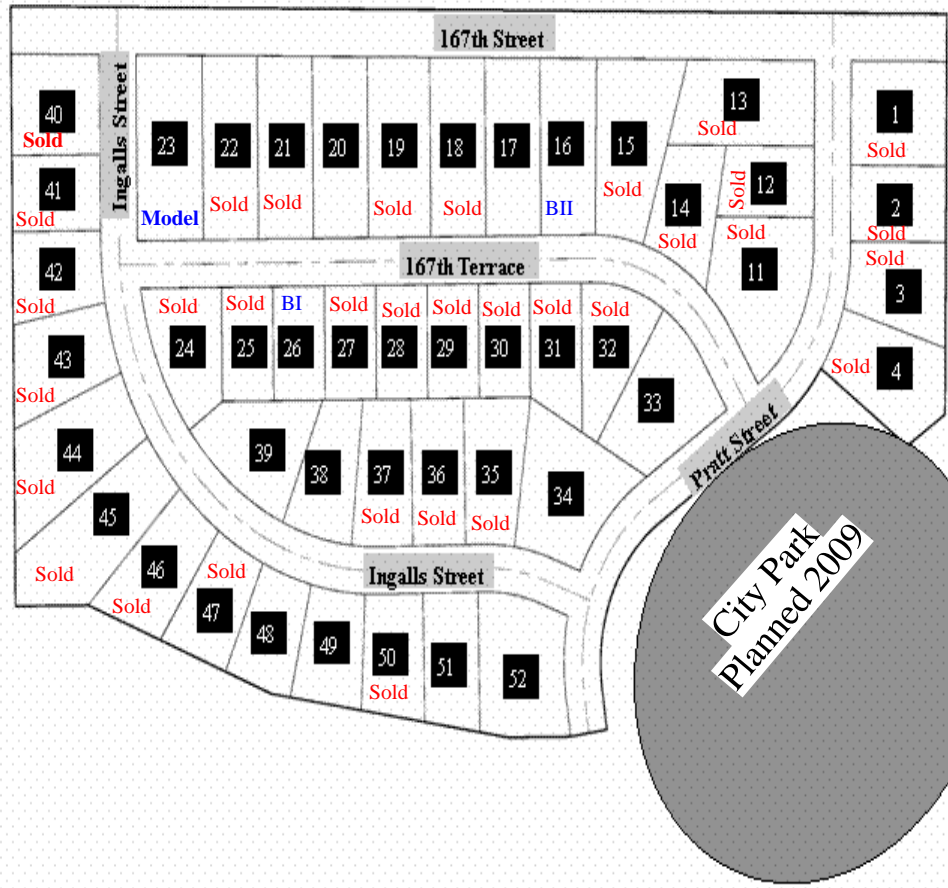

Open Play Fields

City Park  
Planned 2009



**QUAIL MEADOWS**  
 CIVIL ENGINEERS  
 LAND SURVEYORS - LAND PLANNERS  
 HILL & WATERS LIMITED  
 PLATINUM, KANSAS 66201  
 PHONE: 620-766-0800  
 FAX: 620-766-0801

Exclusively marketed by Kaw Valley Real Estate, Gardner KS,